



**John  
BOOS**  
Since 1887

ITEM #: \_\_\_\_\_ QTY: \_\_\_\_\_

MODEL #: \_\_\_\_\_

PROJECT NAME: \_\_\_\_\_

070717

3601 S. Banker St. Effingham, IL 62401 • P.O. BOX 609 • Ph: (888) 431-2667 • Fax: (800) 433-2667

## **"PBMC" MAT CABINET WITH SINK**

### **FEATURES:**

- TYPE 300 STAINLESS STEEL WITH #4 POLISH SATIN FINISH
- ALL EXPOSED HARDWARE IS TAMPER PROOF
- INCLUDES OVERHEAD SHELF FOR STORAGE
- (2) - SWINGING LOCKABLE LOUVERED DOORS
- (1) - 6" DEEP SINK BOWL
- BOTTOMS OF BOWLS FORMED FOR DRAINAGE TO 3-1/2" DIAMETER DIE STAMPED OPENING
- INCLUDES (1) - HEAVY DUTY SERVICE FAUCET (PBF-SS-6)
- INCLUDES (1) - 10" SERVICE FAUCET HOSE (PB-HOSE-120)
- REAR MOUNTED MAT HOLDER
- SIDE MOUNTED MOP HOLDER WITH (2) LOCKING CAMS
- MOUNTING LOCATION OF SERVICE FAUCET CAN BE SPECIFIED BY KITCHEN EQUIPMENT CONTRACTOR

### **CONSTRUCTION:**

- CABINET: STAINLESS STEEL TOPS, CABINETS TIG WELDED, EXPOSED WELDS ARE POLISHED TO MATCH ADJACENT SURFACE

### **MATERIAL:**

- CABINET: 18 GA TYPE 300 STAINLESS STEEL WITH #4 POLISH, SATIN FINISH
- ALUMINUM DOOR LATCH ROD
- 18 GAUGE TYPE 300 SINK BOWL AND DECK
- 20 GAUGE TYPE 300 STAINLESS STEEL BACK

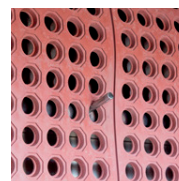

MAT HANGERS



FOLD DOWN  
CHEMICAL SHELF



MOP/BROOM HOLDER

### **MAT CABINET WITH SINK**

MODEL	QTY
PBMC-432683	



PBF-SS-6



PB-HOSE-120

## DETAILED SPECIFICATIONS

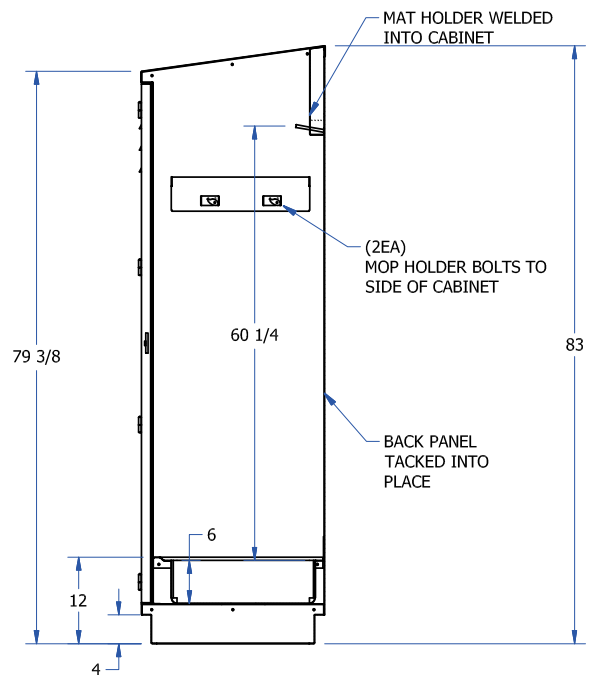
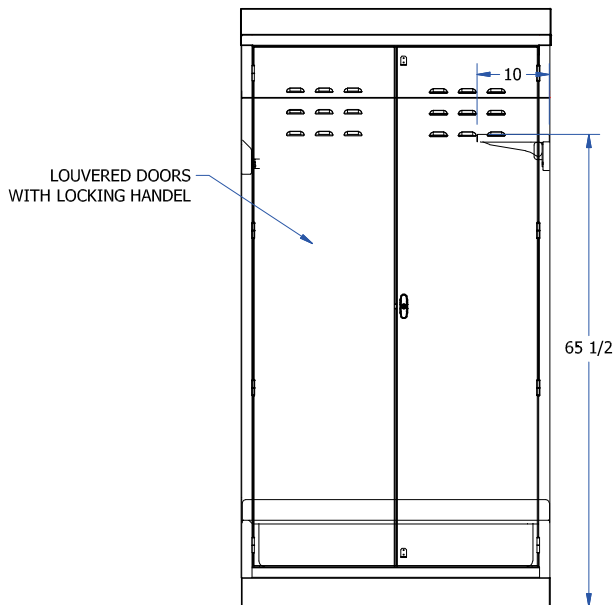
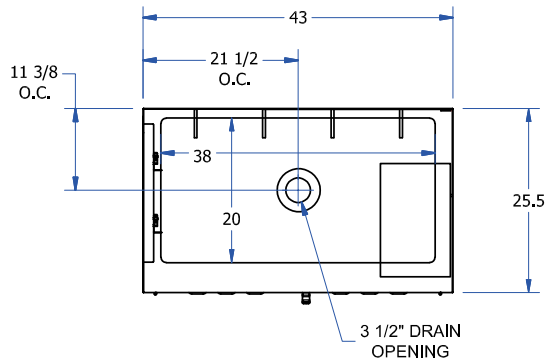

### MAT CABINET WITH SINK

MODEL	OVERALL SIZE (LxWxH)	WEIGHT (LBS)
PBMC-432683	25-1/2" X 43" X 83"	249

SOME UNITS SHIP UNASSEMBLED FOR REDUCED SHIPPING COST. ALL DIMENSIONS ARE TYPICAL. TOLERANCE +/- .500"  
 John Boos & Co. is constantly engaged in a program of improving products and therefore reserves the right to change specifications without prior notice.



Boos  
lock

AQ AutoQuotes

3601 S. Banker St. • Effingham, IL 62401 • PO BOX 609 • quotes@johnboos.com

www.johnboos.com

062217

561